

# SHERIFF™

## SH8 SERIES

### PRODUCT FEATURES:

- » Surface mount – wall or ceiling; 8"×24", 8"×36", 8"×48"
- » ADA Compliant
- » 16-gauge cold rolled steel baseplate with seam welded end caps
- » P12 polycarbonate wraparound lens
- » Peace of Mind Guarantee® against breakage



### PROJECT INFORMATION

Job Name \_\_\_\_\_

Fixture Type \_\_\_\_\_

Catalog Number \_\_\_\_\_

Approved by \_\_\_\_\_

### SPECIFICATIONS

**BASEPLATE:** One-piece, seam welded 16-gauge CRS baseplate and end caps. Baseplate provided with four-point (2 or 3 foot) or six-point (4 foot) mounting holes and one wireway hole – see Cross Section/Details. TGIC polyester powder coat – 5-stage pre-treatment. Salt spray test: 1,000 hours; Reflectance: 92%. Lens is positioned in baseplate channels and retained with stainless steel Torx® fasteners (two fasteners/2 and 3 foot; six fasteners/4 foot). Baseplate/end caps mount flush to ceiling or wall surface.

**LENS:** Cold formed .156" P12 polycarbonate lens. See Options for alternate lenses.

**ELECTRICAL:** **LED:** Available 3000K, 3500K, 4000K and 5000K color temperatures, 82 CRI. 120-277VAC and 347VAC, 50/60Hz electrical input with serviceable high power factor electronic, constant-current driver (<20% THD, >0.95 PF). Standard 0-10V dimming with 1-100% range and dim-to-dark capabilities. 330µA max. source current. Optional embedded microwave motion sensor (MS) has factory default settings of 20 minute time out, dims down to 30%. **LE:** Class P ballasts. Fluorescent electronic 120/277/347 and dual voltage ballasts high power factor.

**SENSOR & CONTROLS:** Optional sensor available with compatible third party controls. To see the full list of compatible controls, [click here](#).

**SOCKETS:** Shock-resistant sockets with internal locking collar to ensure positive lamp retention.

**HARDWARE:** Stainless steel Torx® T-20 with center pin fasteners secure lens in baseplate channel.

**INSTALLATION:** Four-point (2 foot and 3 foot) or six-point (4 foot) mounting required for Peace of Mind Guarantee®.

**WARRANTY:** Limited five (5) year warranty. [Peace of Mind Guarantee against breakage](#).

**LISTINGS:** UL and CUL listed for Wet Location – covered ceilings only. UL and CUL listed for Damp Locations – wall mount. ADA Compliant. Suitable for installation into -40°C to 40°C ambient environments, unless otherwise noted.



### ORDERING INFORMATION (Ex: SH8-48-45L35K-DCC-DV-MS)

Model	Nom. Length	Lamp Qty	Lamp Type	Ballast/Driver	Ballast Qty	Voltage	Options
<b>SH8</b>							
<b>Nominal Length</b>	<b>Lamp Type</b>	<b>Ballast/Driver Type</b>		<b>Options</b>			
24 2'	<b>2' Lengths</b>	<b>DCC</b>	0-10V Dimming LED Driver (LED only)	<b>EL*</b>	Standard Lumen Battery Pack (32°F one-lamp operation)		
36 3'	17 F17T8	<b>IS</b>	Instant Start Electronic <10% THD (T8)	<b>PEL*</b>	High Lumen Battery Pack (32°F one-lamp operation, 4-foot only)		
48 4'		<b>RS</b>	Rapid Start Electronic <10% THD (T8, T5, T5HO)	<b>.187</b>	.187" P12 Polycarbonate Lens		
	<b>3' Lengths</b>	<b>SB</b>	Specified Ballast	<b>AL</b>	Marine Grade Aluminum Housing		
<b>Lamp Quantity*</b>	21 F21T5	<b>Ballast Quantity*</b>		<b>BSS</b>	Brush Stainless Steel Housing		
2 Two Lamps	25 F25T8	1 One		<b>DLN</b>	LED Night Light w/Light Level Control (100% - 20% dimming; voltage-specific selection required; n/a with 347V)		
	39 F39T5HO	2 Two		<b>FS</b>	Single Fuse & Holder		
	<b>4' Lengths</b>	<b>Voltage</b>		<b>KO</b>	Two 1/2" EMT Conduit Entry Knockouts (one per end cap)		
	45L30K 45 Watt 3000K LED	120	120 Volt	<b>OP</b>	Opal Polycarbonate Lens		
	45L35K 45 Watt 3500K LED	277	277 Volt	<b>PM</b>	Pendant Mount		
	45L40K 45 Watt 4000K LED	347	347 Volt (Consult Factory)	<b>PSS</b>	Painted Stainless Steel Housing		
	45L50K 45 Watt 5000K LED	DV	120-277 Volts (<10% THD)	<b>MS</b>	Motion Sensor (4' LED Only; n/a with 347V)		
	67L30K 67 Watt 3000K LED						
	67L35K 67 Watt 3500K LED						
	67L40K 67 Watt 4000K LED						
	67L50K 67 Watt 5000K LED						
	28 F28T5						
	32 F32T8						
	54 F54T5HO						

\* n/a with LED Lamp Type



www.kenall.com | P: 800-4-Kenall | F: 262-891-9701 | 10200 55th Street Kenosha, Wisconsin 53144, USA

A brand of **legrand**

This product complies with the Buy American Act: manufactured in the United States with more than 50% of the component cost of US origin. It may be covered by patents found at [www.kenall.com/patents](http://www.kenall.com/patents). Content of specification sheets is subject to change; please consult [www.kenall.com](http://www.kenall.com) for current product details. ©2022 Kenall Mfg. Co.

# SHERIFF™

## SH8 SERIES

### PERFORMANCE

Lamp Type	Initial Delivered Lumens		Input Power (W)	Drive Current (mA)	Estd. L70 LED Life (Hrs)
	@ 25°C	Efficacy (lm/W)			
45L30K	4,595	96	48	100	80,000
45L35K	4,737	99			
45L40K	4,899	102			
45L50K	5,234	109			
67L30K	7,020	97	72	75	80,000
67L35K	7,237	101			
67L40K	7,484	104			
67L50K	7,996	111			

Information subject to change without notice. Photometry tested to the IESNA LM-79-08 standard by an ILAC/ISO17025 accredited laboratory. For photometric data, please go to [www.kenall.com](http://www.kenall.com)

Model: SH8-48-67L40K-DCC-DV

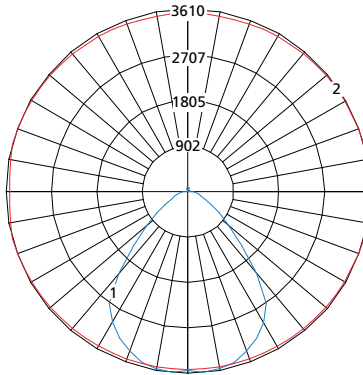

Maximum Candela = 3610 Located At Horizontal Angle = 15, Vertical Angle = 5

- 1 - Vertical Plane Through Horizontal Angles (15-195) (Through Max. Cd.)
- 2 - Horizontal Cone Through Vertical Angle (5) (Through Max. Cd.)

### DIMENSIONAL DATA

#### CROSS SECTION

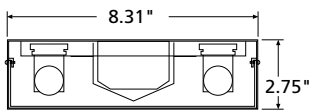

#### BASEPLATE

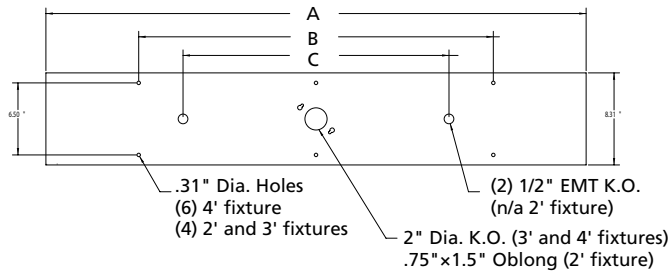

#### DIMENSIONAL DATA (IN INCHES)

	A	B	C
8x24	24.75	16.00	n/a
8x36	36.75	24.00	24.00
8x48	48.75	32.00	24.00



[www.kenall.com](http://www.kenall.com) | P: 800-4-Kenall | F: 262-891-9701 | 10200 55th Street Kenosha, Wisconsin 53144, USA

A brand of **Legrand**

This product complies with the Buy American Act: manufactured in the United States with more than 50% of the component cost of US origin. It may be covered by patents found at [www.kenall.com/patents](http://www.kenall.com/patents). Content of specification sheets is subject to change; please consult [www.kenall.com](http://www.kenall.com) for current product details. ©2022 Kenall Mfg. Co.